

CATALOG NO.	LID TYPE	WT. LBS.
VBU-8215	WATER	13

\*NOTE: LETTERING ALSO AVAILABLE IN "SEWER", "GAS", "FAPID", & "IRRIG"

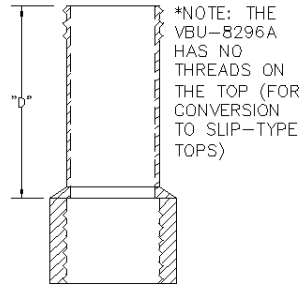

CATALOG NO.	EXTENSION "D"	WT. LBS.
VBU-8295	14	28
VBU-8296	18	33
VBU-8296A	18	33
VBU-8297	24	36

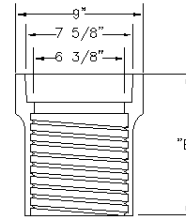

CATALOG NO.	SCREW TOP "B"	WT. LBS.
VBU-8360	10	22
VBU-8370	16	37
VBU-8380	26	52

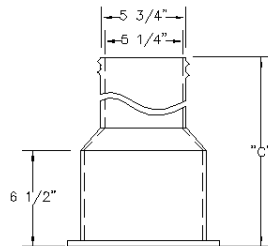

CATALOG NO.	SCREW BASE "C"	WT. LBS.
VBU-8385	24	35
VBU-8390	36	45

NOTES:

## OLYMPIC FOUNDRY INC.

### 5 1/4" SCREW TYPE VALUE BOXES

MATL: Cast Iron ASTM A48, CL30

RATING: H-20

PART NO. VBU-8215 Through VBU-8390

APPROX WT: See Above

REV: A DATE: 3/5/1999

REV  
A

DOCUMENT APPROVED  
BY: DATE:

DWN: DATE:

CHKD: DATE:

TOLERANCE  
XX +.1  
XXX +.06  
XXXX +.030  
< + 2 DEG

REV: DATE:

DWG #: VBU-8215 Through VBU-8390

SCALE: N/A

SHEET: 1 OF 1