

WATER AND SEWER COVERS HAVE 1 - 1" LIFT HOLE,
DRAIN COVERS HAVE 3 - 1" LIFT HOLES

1/2" X 3" X 3/8" NON-SKID
PATTERN CAST
INTEGRAL ON TOP

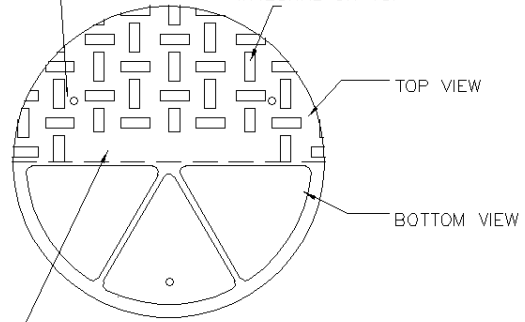

LETTERS AS SPECIFIED
(WATER, SEWER, ETC.)
TO BE PLACED HERE

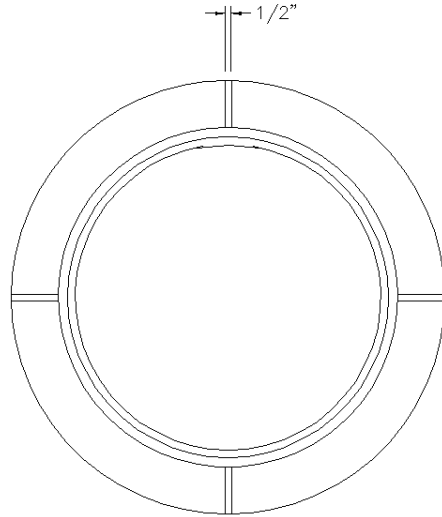
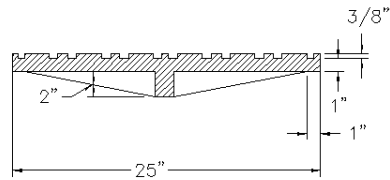

COVER

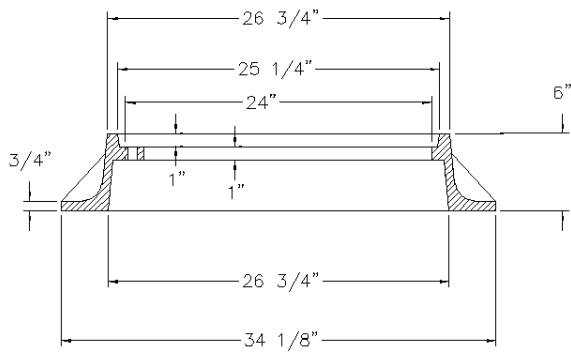

NOTES:

OLYMPIC FOUNDRY INC.

24" X 6" MANHOLE RING & COVER

MATL: Cast Iron ASTM A48, CL30

RATING: H-20

PART NO. MH30K

APPROX WT: Ring 160 Lbs, Cover 150 Lbs

REV: A DATE: 6/23/2003 New border

REV
A

DOCUMENT APPROVED
BY: DATE:

DWN: CL DATE: 6/23/2007

CHKD: CL DATE: 6/23/2003

TOLERANCE
XX +/- .1
XXX +/- .06
XXXX +/- .030
<+ 2 DEG

REV: DATE:

DWG #: MH30K

SCALE: N/A

SHEET: 1 OF 1